

TENTUBE SERIES CONNECTOR



CONNECT UP TO 10 TUBES
IN ONE EASY MOTION!

The Tentube™ coupling provides one easy-to-use quick disconnect for up to ten separate fluid lines. The Tentube is available with valves on the body side in panel mount or in-line configurations for maximum design flexibility. The Tentube can connect and disconnect up to ten lines with the use of a simple slide latch. Tubing orientation is ensured by keying the coupling body and insert. Different fluids and tubing sizes can be accommodated by using acetal or polypropylene inserts in three popular sizes.

FEATURES

Ten line connection
Separate flow paths
Insert is keyed to body
Acetal or polypropylene inserts

BENEFITS

Fast, efficient operation
Pressure and/or vacuum in one coupling
Ensures correct line orientation
Maximize design flexibility

Specifications

PRESSURE:

Vacuum to 100 psi, 6.9 bar per line

TEMPERATURE:

Acetal fitting inserts:
-40°F to 180°F (-40°C to 82°C)

Polypropylene fitting inserts:
32°F to 180°F (0°C to 82°C)

MATERIALS:

Main components: Nylon

Valves: Acetal

Valve springs: 316 stainless steel

Fitting inserts: Acetal or polypropylene

O-rings: Buna-N with acetal
or EPDM with polypropylene

Panel mount adapter: Acetal

Tube shroud: Acetal

COLOR:

Main components:

Black with red locking latch

Tube shroud: Black

Panel mount adapter: Black

TUBING SIZES:

1/16" to 1/8" ID, 1.6mm to 3.2mm ID

These graphs are intended to give you a general idea of the performance capabilities of each product line. The shaded area of each graph represents the operating range of the product family, i.e., upper and lower values are shown. Therefore, depending on the exact coupling configurations selected, you can reasonably expect values to fall within the shaded area.

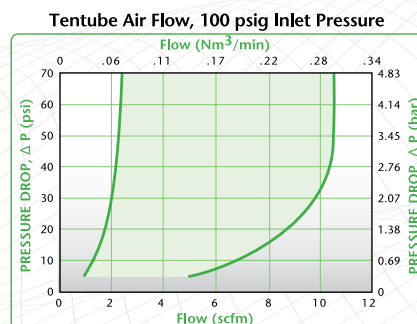
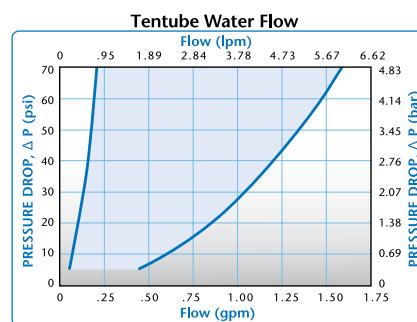

TENTUBE DIMENSIONS

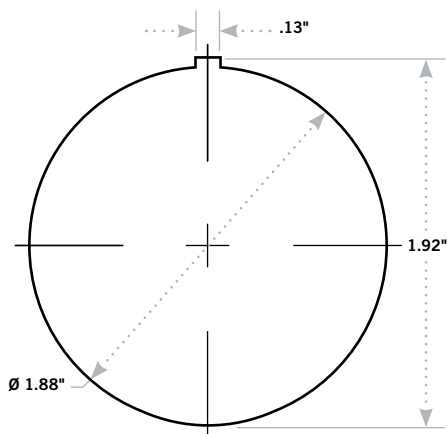

Panel Dimensions

	PANEL OPENING	PANEL THICKNESS MAX.–MIN.
COUPLING BODIES	see drawing	.44–.06

Fitting Bodies • ACETAL/POLYPROPYLENE



TERMINATION COMPLETE COUPLING SET

COUPLING BODY WITH FEMALE FITTING BODIES

COUPLING INSERT WITH MALE FITTING INSERTS

TUBING SIZE	METRIC EQ.	ACETAL STRAIGHT THRU	ACETAL SHUTOFF	POLYPROPYLENE STRAIGHT THRU
1/16" ID	1.6mm ID	TT1001	TTD1001	TT100112
	3.0mm ID	TT10M3	TTD10M3	
1/8" ID	3.2mm ID	TT1002	TTD1002	TT100212
1/16" ID	1.6mm ID	TFB1001	TFBD1001	TFB100112
	3.0mm ID	TFB10M3	TFBD10M3	
1/8" ID	3.2mm ID	TFB1002	TFBD1002	TFB100212
Without fitting bodies		TFB10		
1/16" ID	1.6mm ID	TMB1001		TMB100112
	3.0mm ID	TMB10M3		
1/8" ID	3.2mm ID	TMB1002		TMB100212
Without fitting inserts		TMB10		

Fitting Inserts • ACETAL/POLYPROPYLENE



TERMINATION IN-LINE PIPE THREAD

IN-LINE PIPE THREAD (FEMALE)

TUBING SIZE	METRIC EQ.	ACETAL STRAIGHT THRU	ACETAL SHUTOFF	POLYPROPYLENE STRAIGHT THRU
1/16" ID	1.6mm ID	TMF01		TMF0112
	3.0mm ID	TMFM3		
1/8" ID	3.2mm ID	TMF02		TMF0212
1/16" ID	1.6mm ID	TFF01	TFFD01	TFF0112
	3.0mm ID	TFFM3	TFFDM3	
1/8" ID	3.2mm ID	TFF02	TFFD02	TFF0212

Note: Acetal bodies and inserts are also available in white. To order, add MWHT to the end of the part number.

Accessories



DESCRIPTION

TUBE SHROUD: snaps into either half

PART NO.

TS10

PANEL MOUNT ADAPTER & NUT: 7/16" max. panel thickness; requires 1.875" diameter hole

TPM10

Note: Use TMF and TFF inserts and bodies for custom designed assemblies.

All measurements are in inches (millimeters) unless otherwise noted. Tubing must meet stated inside and outside diameters. Couplings are pictured with valves unless otherwise noted.

TWIN TUBE & SIXTUBE SERIES CONNECTOR

Twin Tube Specifications

PRESSURE:

Vacuum to 120 psi, 8.3 bar per line

TEMPERATURE:

-40°F to 180°F (-40°C to 82°C)

MATERIALS:

Main components: Acetal, ABS

Valves: Acetal

Thumb latch: Stainless steel

External springs and pin: Stainless steel

O-rings: Buna-N

COLOR: Natural white with aqua latch

TUBING SIZES:

1/16" to 1/8" ID, 1.6mm to 3.2mm ID

Sixtube Specifications

PRESSURE:

Vacuum to 100 psi, 6.9 bar per line

TEMPERATURE:

Acetal fitting inserts:

-40°F to 180°F (-40°C to 82°C)

Polypropylene fitting inserts:

32°F to 180°F (0°C to 82°C)

MATERIALS:

Main components: Acetal

Valves: Acetal

Fitting inserts: Acetal, polypropylene

Thumb latch: Acetal

Valve spring: 316 stainless steel

O-rings: Buna-N with acetal or EPDM with polypropylene

COLOR: Natural white with aqua latch

TUBING SIZES:

1/16" to 1/8" ID, 1.6mm to 3.2mm ID

NOTE: Caution must be observed when ordering Sixtube assemblies. Body and insert halves which both contain female or male fittings will not couple. Contact CPC for questions and ordering assistance.

The Twin Tube™ coupling provides one easy-to-use quick disconnect for two separate fluid lines. The non-valved Twin Tube maintains two individual flow paths in one coupling. Featuring the CPC thumb latch, the Twin Tube can disconnect two lines with the push of a button. The panel mount design keeps a low profile on the front of the equipment panel.

The Sixtube™ coupling provides one easy-to-use quick disconnect for up to six separate fluid lines. The Sixtube is available with valves on either side for maximum design flexibility. Featuring the CPC thumb latch, the Sixtube can disconnect up to six lines with the push of a button. The snap-in panel mount design keeps a low profile on the front of the equipment panel.

FEATURES

Two/six line connection

Separate flow paths

Sixtube insert is keyed to body

Free coupling rotation (Twin Tube)

CPC thumb latch

BENEFITS

Fast, efficient operation

Pressure and/or vacuum in one coupling

Ensures correct line orientation

Eliminates kinked tubing

One-hand connection and disconnection

These graphs are intended to give you a general idea of the performance capabilities of each product line. The shaded area of each graph represents the operating range of the product family, i.e., upper and lower values are shown. Therefore, depending on the exact coupling configurations selected, you can reasonably expect values to fall within the shaded area.

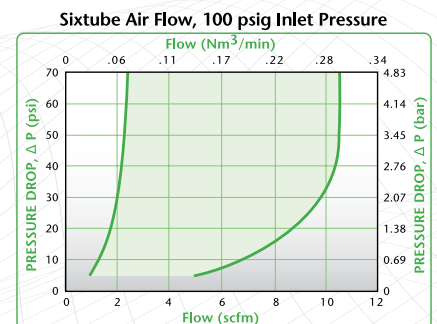
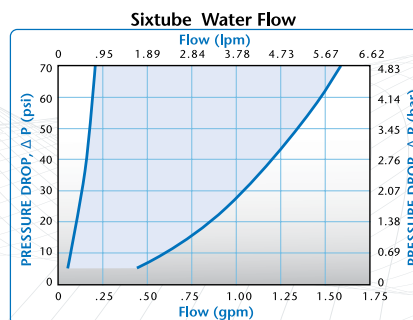
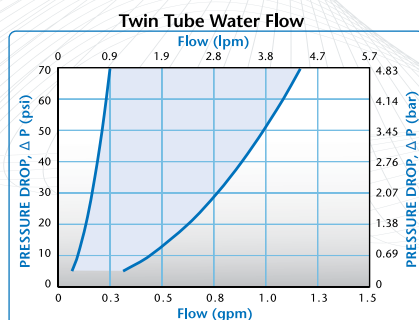

TWINTUBE & SIXTUBE DIMENSIONS

Twin Tube™ Body Panel Mount Dimensions

	PANEL NUT HEX	PANEL NUT THREAD
COUPLING INSERTS	13/16	11/16-24UNEF

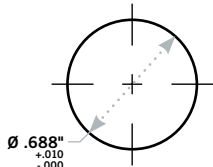

Maximum Panel Thickness: 1/2"
Minimum Panel Thickness: 0.02"

Sixtube™ Insert Panel Mount Dimensions

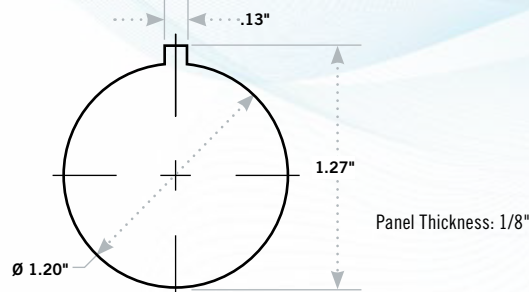

Twintube Coupling Bodies • ACETAL/ABS



ABS part shown

**TERMINATION
PANEL MOUNT
HOSE BARB**

TUBING SIZE
1/16" ID
1/8" ID

METRIC EQ.
1.6mm ID
3.2mm ID

**ACETAL
STRAIGHT THRU**
PTC16010
PTC16020

**ABS
STRAIGHT THRU**
PTC1602096

Twintube Coupling Inserts • ACETAL/ABS



Acetal part shown

**TERMINATION
IN-LINE
HOSE BARB**

TUBING SIZE
1/16" ID
1/8" ID

METRIC EQ.
1.6mm ID
3.2mm ID

**ACETAL
STRAIGHT THRU**
PTC22010
PTC22020

**ABS
STRAIGHT THRU**
PTC2202096

Sixtube Coupling Bodies • ACETAL/POLYPROPYLENE



Acetal part shown

**TERMINATION
WITH MALE FITTING
INSERTS**

TUBING SIZE
1/16" ID
1/8" ID

METRIC EQ.
1.6mm ID
3.0mm ID
3.2mm ID

**ACETAL
STRAIGHT THRU**
SXM1701
SXM17M3
SXM1702

**ABS
SHUTOFF**

**POLYPROPYLENE
STRAIGHT THRU**
SXM170112

**WITH FEMALE
FITTING BODIES**

1/16" ID
1/8" ID

1.6mm ID
3.0mm ID
3.2mm ID

SXF1701
SXF17M3
SXF1702

SXFD1701
SXFD17M3
SXFD1702

SXF170112
SXF170212

WITHOUT FITTINGS

SX17

Sixtube Coupling Inserts • ACETAL/POLYPROPYLENE



Acetal part shown

**TERMINATION
WITH MALE FITTING
INSERTS**

TUBING SIZE
1/16" ID
1/8" ID

METRIC EQ.
1.6mm ID
3.0mm ID
3.2mm ID

**ACETAL
STRAIGHT THRU**
SXM4201
SXM42M3
SXM4202

**ABS
SHUTOFF**

**POLYPROPYLENE
STRAIGHT THRU**
SXM420112

**WITH FEMALE
FITTING BODIES**

1/16" ID
1/8" ID

1.6mm ID
3.0mm ID
3.2mm ID

SXF4201
SXF42M3
SXF4202

SXFD4201
SXFD42M3
SXFD4202

SXF420112
SXF420212

WITHOUT FITTINGS

SX42

Accessories

DESCRIPTION
SIXTUBE PRESSURE PLUGS

PART NO.
TMPMWH7

MULTI-MOUNT SERIES CONNECTOR

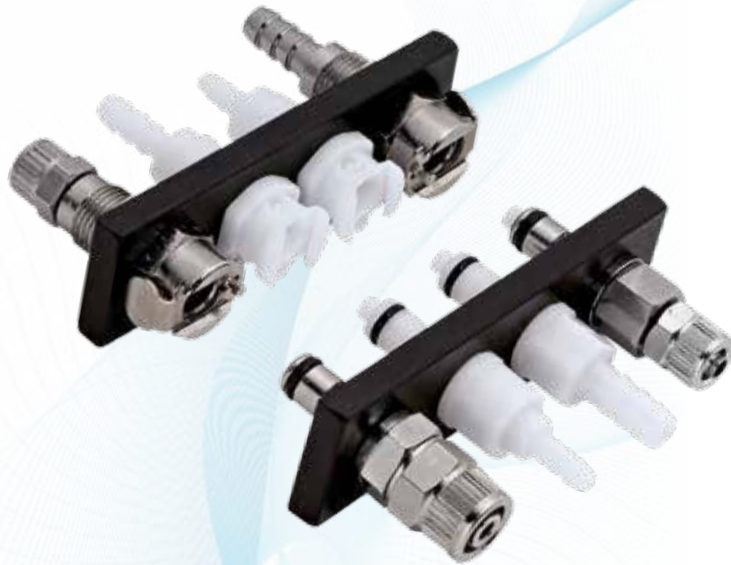

Multi-Mount couplings provide one easy-to-use coupling for connecting from three to five lines at once. Multi-mount couplings are available in a wide variety of materials including acetal and chrome-plated brass. Multi-mounts are keyed to prevent mismatched connections and can be configured with or without valves for maximum design flexibility.

FEATURES

Three to five line connection
Separate flow paths
Insert is keyed to body
Acetal or chrome-plated brass

BENEFITS

Fast, efficient operation
Pressure and/or vacuum in one coupling
Ensures correct line orientation
Maximize design flexibility

Specifications

PRESSURE:

Minimum: Vacuum

Maximum: Brass = 500 psi / no. of stations
or Acetal = 240 psi / no. of stations

TEMPERATURE:

-40°F to 180°F (-40°C to 82°C)

MATERIALS:

Main components: Acetal or chrome-plated brass

Thumb latch: Stainless steel

Mounting Plate: Black anodized aluminum

Valves: Acetal

Valve spring: 316 stainless steel

External springs and pin: Stainless steel

O-ring: Buna-N

TUBING SIZES:

1/8" to 3/8" ID, 3.2mm to 9.5mm ID

Retaining clip is included with each insert

Multiple mount inserts are designed for mounting in 1/4" thick plates

Note: To order in chrome-plated brass, eliminate the "P" at the beginning of the part number.

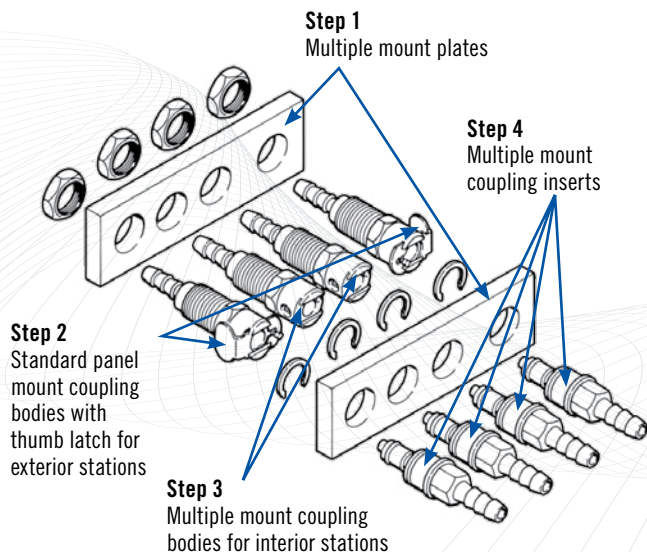

Four-Step Multi-Mount Ordering Process

STEP 1: Determine flow size and termination type.

STEP 2: Order two "multiple mount plates" (one for the coupling bodies and one for the coupling inserts) with the appropriate number of connection stations for your specific application (available in 3, 4, or 5 connections, or construct your own). Refer to next page.

STEP 3: Order two "standard panel mount coupling bodies with thumb latches" for the exterior stations.

STEP 4: Order an appropriate number of "multiple mount coupling bodies without thumb latches" to accommodate the remaining interior stations.

STEP 5: Order an appropriate number of "multiple mount inserts" to connect with standard and multiple mount bodies.

MULTI-MOUNT SERIES DIMENSIONS

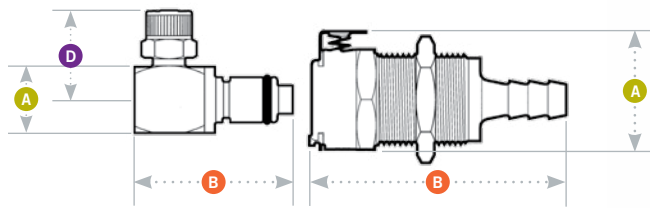

A = Height/Diameter **B** = Total Length **D** = Elbow Radial Length

Multiple mount plates are keyed to prevent misconnections. >>
Multiple mount minimum coupling spacing: CPC offsets the last hole on the mounting plates so they cannot be misconnected.

MM SERIES 1/8" Flow

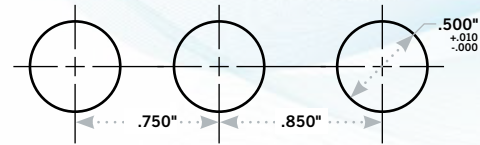

LM SERIES 1/4" Flow

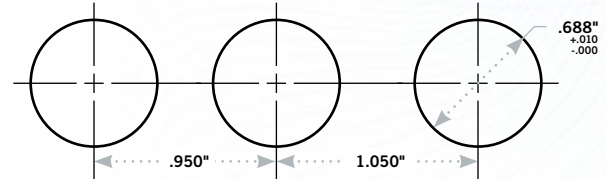

Multiple Mount Plates

Information in RED indicates 1/8" flow couplings. These are not compatible with 1/4" flow couplings in non-shaded sections.



NUMBER OF STATIONS	1/8" FLOW SIZE	LENGTH	1/4" FLOW SIZE	LENGTH
3	CP103	2.60	LCP103	3.00
4	CP104	3.35	LCP104	3.35
5	CP105	4.10	LCP105	4.90

Retaining Rings

COUPLING SERIES	PART NO. (REPLACEMENTS)
MC/PMC	101700
LC/PLC	278100

Coupling Bodies • ACETAL



TERMINATION
PANEL MOUNT
FERRULELESS
POLYTUBE FITTING,
PTF†

**PANEL MOUNT
HOSE BARB**

**PANEL MOUNT
FEMALE THREAD**

TUBING/THREAD SIZE	METRIC EQ.	STRAIGHT THRU	SHUTOFF	A	B	D
1/4" OD, .17" ID	6.4mm OD, 4.3mm ID	PMM1204	PMMD1204	.72	1.72	
1/4" OD, .17" ID	6.4mm OD, 4.3mm ID	PLM12004	PLMD12004	.94	1.82	
3/8" OD, .25" ID	9.5mm OD, 6.4mm ID	PLM12006	PLMD12006	.94	1.95	
1/8" ID	3.2mm ID	PMM1602	PMMD1602	.72	1.65	
3/16" ID	4.8mm ID	PMM1603	PMMD1603	.72	1.85	
1/4" ID	6.4mm ID	PMM1604	PMMD1604	.72	1.85	
1/4" ID	6.4mm ID	PLM16004	PLMD16004	.94	1.95	
5/16" ID	7.9mm ID	PLM16005	PLMD16005	.94	1.95	
3/8" ID	9.5mm ID	PLM16006	PLMD16006	.94	1.95	
10-32 UNF		PMM181032	PMMD181032	.72	1.25	

Coupling Inserts • ACETAL



TERMINATION
IN-LINE
FERRULELESS
POLYTUBE FITTING,
PTF†

**IN-LINE
HOSE BARB**

**ELBOW
FERRULELESS
POLYTUBE FITTING,
PTF†**

TUBING/THREAD SIZE	METRIC EQ.	STRAIGHT THRU	SHUTOFF	A	B	D
5/32" OD, .10" ID	4.0mm OD, 2.5mm ID	PMM20025	PMMD20025	.58	1.86/1.96	
1/4" OD, .17" ID	6.4mm OD, 4.3mm ID	PMM2004	PMMD2004	.58	1.77/1.87	
1/4" OD, .17" ID	6.4mm OD, 4.3mm ID	PLM20004	PLMD20004	.72	2.10/2.23	
3/8" OD, .25" ID	9.5mm OD, 6.4mm ID	PLM20006	PLMD20006	.72	2.02/2.15	
1/8" ID	3.2mm ID	PMM2202	PMMD2202	.56	1.87/1.97	
3/16" ID	4.8mm ID	PMM2203	PMMD2203	.58	2.08/2.18	
1/4" ID	6.4mm ID	PMM2204	PMMD2204	.58	1.83/1.93	
1/4" ID	6.4mm ID	PLM22004	PLMD22004	.72	2.20/2.33	
5/16" ID	7.9mm ID	PLM22005	PLMD22005	.72	2.20/2.33	
3/8" ID	9.5mm ID	PLM22006	PLMD22006	.72	2.03/2.16	
1/4" OD, .17" ID	6.4mm OD, 4.3mm ID	PMM2104	PMMD2104	.53	1.41/1.51	.77

All measurements are in inches (millimeters) unless otherwise noted. Tubing must meet stated inside and outside diameters. Couplings are pictured with valves unless otherwise noted. †NOTE: CPC's Ferruleless Polytube Fitting terminations do not require ferrules to achieve a secure connection, which makes them easier to use and reuse. PTF fittings are designed for semi-rigid tubing, i.e., polyethylene, nylon, polyurethane, etc.

BQ45GL SERIES CONNECTOR

Specifications ● ● ●

TEMPERATURE:

32°F to 120°F (0°C to 49°C)

MATERIALS:

Base Cap: High density polyethylene

Gasket: Low density polyethylene

Packaging Vent: Hydrophobic PTFE

Quick Disconnects: Polypropylene, with 316 stainless steel springs and EPDM o-rings

FitQuik Connector: Polypropylene

COLOR: Blue

TUBING SIZES:

FitQuik connector: 1/4" OD

DIP tube interface: 1/4" ID

WARNING: Pressure, temperature, chemicals, and operating environment can affect the performance of couplings. It is the customer's responsibility to test the suitability of CPC products in their own application conditions.



BQ45GL Series Bottle Caps include a quick disconnect coupling or FitQuik® connector integrated into a cap designed for 45GL bottles. The BQ45GL series feature a hydrophobic packaging vent, polyethylene gasket and a hose barb for mounting a dip tube. Adding quick disconnects to media bottles makes changing laboratory consumable products safer and easier.

FEATURES

Factory installed quick disconnects

Hydrophobic packaging vent

Polyethylene foam gasket

Integral hose barb

BENEFITS

Ensures cap properly seals to bottle (even without sealing rings)

Encourages proper fluid handling protocol allowing easy disconnections to replace or refill consumables in the correct location

Allows dispensing from container while preventing accidental spillage

Allows for mounting of 1/4" ID DIP tube

BQ45GL DIMENSIONS

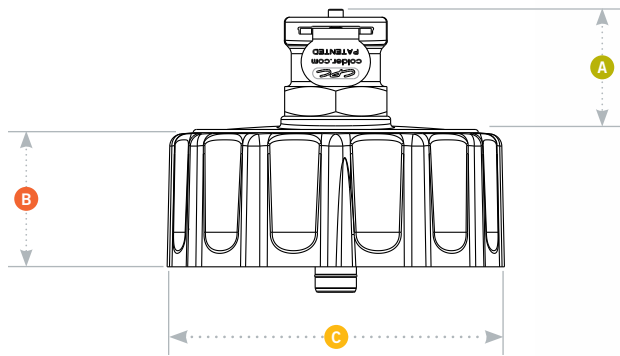

- A = Coupling
- B = Cap Height
- C = Cap Diameter

Bottle Caps • POLYETHYLENE



DESCRIPTION
 GL45 HDPE CAP WITH POLYETHYLENE FOAM SEALING GASKET, HYDROPHOBIC VENT AND INTEGRAL VALVED PMC12 BODY QUICK DISCONNECT INTERFACE

GL45 HDPE CAP WITH POLYETHYLENE FOAM SEALING GASKET, HYDROPHOBIC VENT AND INTEGRAL VALVED PMC12 INSERT QUICK DISCONNECT INTERFACE

GL45 HDPE CAP WITH POLYETHYLENE FOAM SEALING GASKET, HYDROPHOBIC VENT AND INTEGRAL POLYPROPYLENE ELBOW FITTING (WITH 1/4" HOSE BARB)

PART NO.	DIP TUBE SIZE	CONNECTOR SIZE	A	B	C
BQ45GL1001	1/4" ID	1/4" OD	0.68"	0.83"	2.04"
BQ45GL2001	1/4" ID	1/4" OD	1.08"	0.83"	2.04"
BQ45GL5001	1/4" ID	1/4" OD	0.63"	0.83"	2.04"

NOTES:

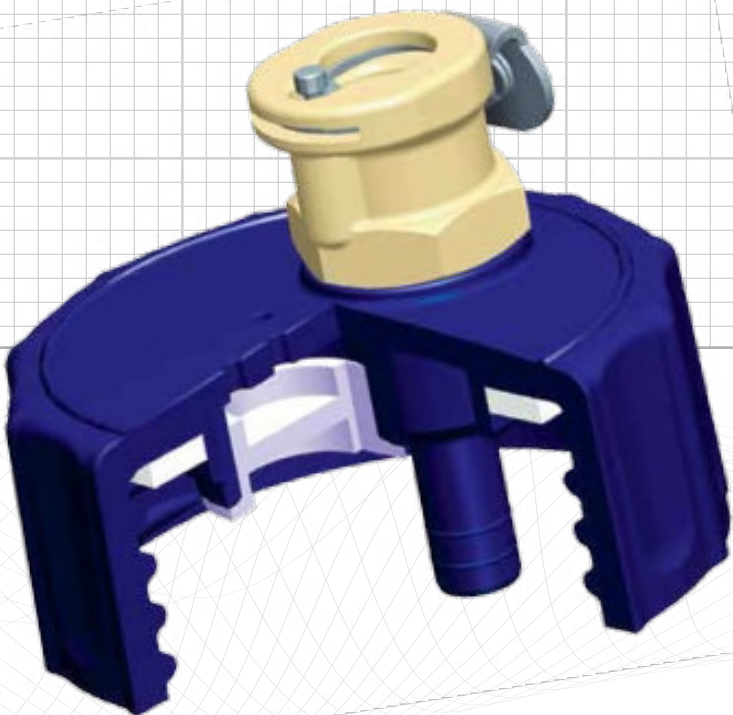

HYBRID SERIES CONNECTOR



Hybrid Connectors integrate air lines, electrical connections and fluid lines into a single, compact connection point for remote tools on medical devices and equipment. Eliminating the potential for misconnecting tubing and wires, CPC's Hybrid Connector platform options reduce multiple connections and allow clinicians or patients to quickly and easily change or replace modular tools, umbilicals or hand pieces.

Large Format Hybrid Connector – Now available with four times the flow capacity, this connector features multiple dry-break couplings and easy-to-use twist latch for secure, repeatable connection of multiple lines.

Specifications ● ● ●

PRESSURE:

Vacuum to 45 psi, 3.1 bar

TEMPERATURE:

32°F to 120°F (0°C to 49°C)

MATERIALS:

Non-wetted coupler components: Glass-filled polypropylene

Wetted coupler components: Glass-filled polypropylene

Springs: Stainless steel

Electrical contacts: Gold-plated copper alloy

O-rings: EPDM

Fluid tubing: Polyurethane (PU)

Umbilical tubing: PVC

COLOR: Gray

TERMINATIONS:

Panel: Two 1/8" (3.2mm) hose barbs on panel and four 20 ga wires with 12" (304.3mm) pigtail

Umbilical Hose: 8' (2.44M) umbilical with two 1/8" (3.2mm) ID PU tubing and four 20ga wires with 3" (76.2mm) pigtail

NUMBER OF FLUID LINES: 2

ELECTRICAL SPECIFICATIONS

Voltage: Up to 24VDC

Current: Up to 3 Amps

Wire gauge: 20AWG

Number of contacts: 4

FEATURES

Single connection point for pneumatic, fluid, and power connections between a device and its tool/hand piece

Non-spill shutoff valves with dry-break technology

Turnkey solution

Off-the-shelf assembly

Custom options available

BENEFITS

Increases safety and makes systems data more user friendly

Eliminate fluid drips upon disconnect and minimize air inclusion

Reduces multiple components

Minimizes engineering design and manufacturing effort

Flexibility to add additional fluid connector or electrical contacts

HYBRID SERIES DIMENSIONS

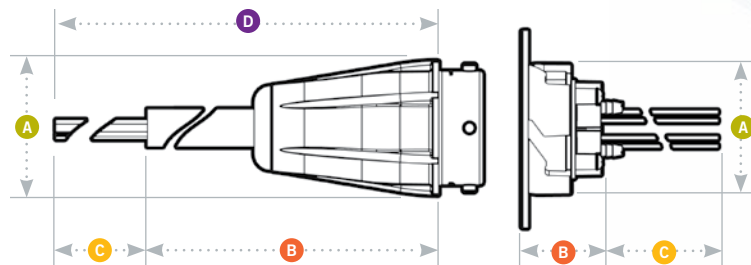

A = Height/Diameter B = Total Length C = Pigtail D = Umbilical

Panel Dimensions

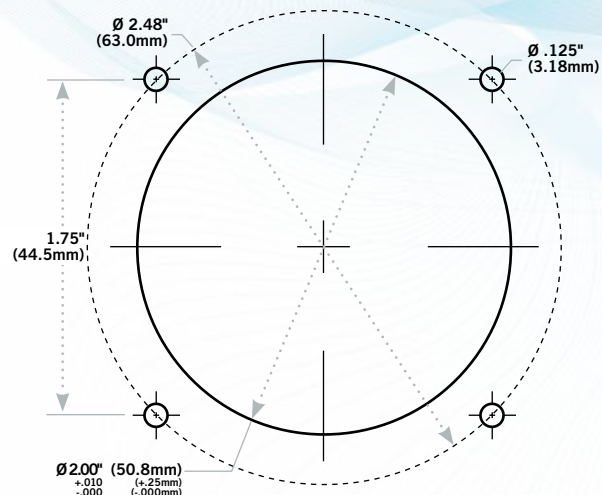

Coupling Hose • POLYPROPYLENE



CONFIGURATION
HOSE

FLOW PATHS
1/8" ID (3.2mm)

PART NO.
HQC17002

A
2.00

B
2.80

C
3.00

D
8.00

Coupling Panel • POLYPROPYLENE



CONFIGURATION
PANEL MOUNT

FLOW PATHS
1/8" ID (3.2mm)

PART NO.
HQC42001

A
1.96

B
1.12

C
12.00

D

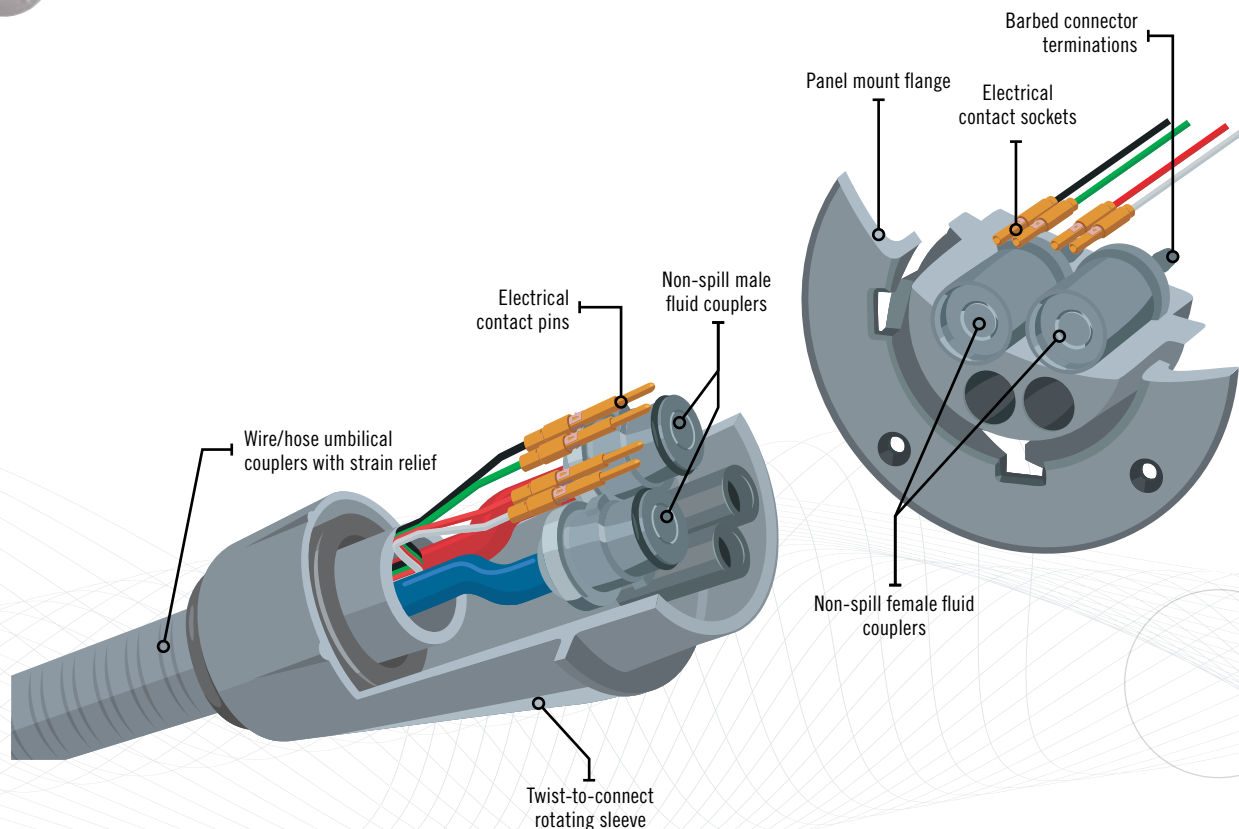

MINI HYBRID SERIES CONNECTOR



Mini Hybrid Connector – A compact, single connection point with a smaller form factor that is ideal for use in low-pressure applications where ease of use and ergonomics are important. This connector makes it easy to connect power, signal and gases in one simple motion.

FEATURES

Easy-to-use breakaway design
Small package design
Streamlined exterior
Proven design

BENEFITS

Quick, automatic disconnect
Minimize device size
Clean, attractive appearance
Accelerate product development

Specifications ● ● ●

PRESSURE:

Vacuum to 25 psi, 1.7 bar

TEMPERATURE:

40°F to 80°F (4°C to 27°C)

MATERIALS:

External coupler components: PET

Air coupler components: Acetal

Springs: Stainless steel

Panel Mount Nut: Zinc-plated steel

Electrical contacts: Gold-plated copper alloy

O-rings: Buna-N

Air line: PVC

COLOR: Gray

EXTERNAL UMBILICAL HOSE: 4 feet (121 cm) PVC

WIRE: 22AWG PVC jacket

TERMINATIONS:

Panel: 1/16" hose barb and two 22AWG wires with 11" pigtail

Umbilical: 4' (121 cm) umbilical with one 1/16" ID PVC tube and two 22AWG wires with 6" pigtail

Number of air lines: 1

ELECTRICAL SPECIFICATIONS

Voltage: Up to 24VDC

Current: Up to 3 Amps

Wire: 22AWG with PVC jacket

Number of contacts: 2

MINI HYBRID SERIES DIMENSIONS

Panel Dimensions

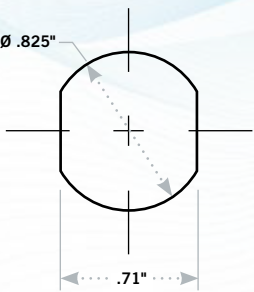
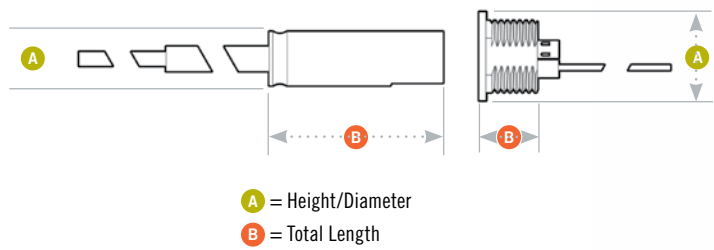

Coupling Hose • PET AND ACETAL

	CONFIGURATION HOSE	FLOW PATH 1/16" ID (1.6mm)	PART NO. MHQC17000	A .62	B 2.00
---	------------------------------	--------------------------------------	------------------------------	-----------------	------------------

Coupling Panel • PET AND ACETAL

	CONFIGURATION PANEL MOUNT	FLOW PATH 1/16" ID (1.6mm)	PART NO. MHQC42000	A 1.00	B .60
---	-------------------------------------	--------------------------------------	------------------------------	------------------	-----------------

NOTES:

